

Combination of 感性与理性的结合 Sense and sensibility

坚持精致的工艺，严谨考究细节的态度，是庐威一直保持高品质的主题。



PROCUREMENT SERVICES FROM
B D F S
BuyDirectFromSuppliers.com

Manufactured in Mexico-China-Brazil-USA-Bahrain

Brent Gilbertson Mobile: 678-361-5559
Managing Partner/Founder Brent@BuyDirectFromSuppliers.com

Type:Screwed,Hose,head

Material Quality:SUS304,SUS316

Size:DN8-100&1/4"-4"

Applicable Mediums:WOG & Every kind of cerrosive
mediums suitable for CF8M/CF8

KEY FEATURE

连接形式: 螺纹、软管、焊接

材质为: SUS304, SUS316制成

管道流量控制: DN8-100及1/4"-4"

适用介质: 水、油、气体及与CF8M/CF8适宜的各种腐蚀性介质

内接头 Hexagon Nipple

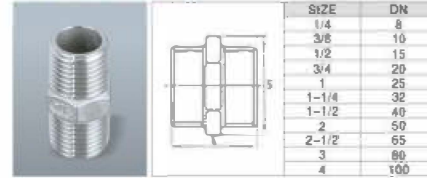

外接头 Socket Banded

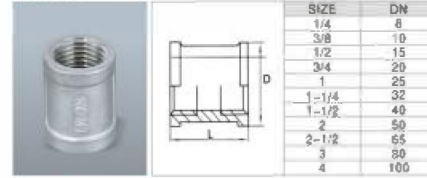

45°弯头 45°Elbow

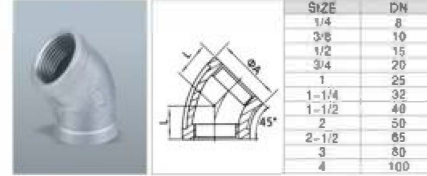

90°弯头 90°Elbow

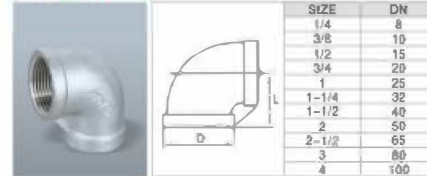

异径弯头Reducer Elbow

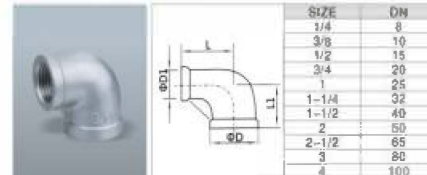

抛光皮管外牙 King Nipple

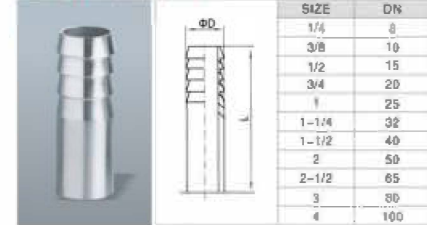

水管接头 Hose Nipple

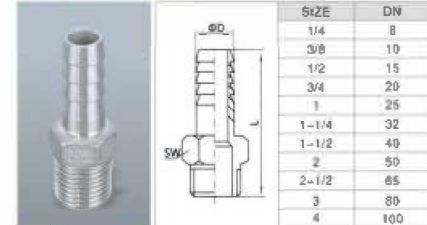

堵头 Square Plug

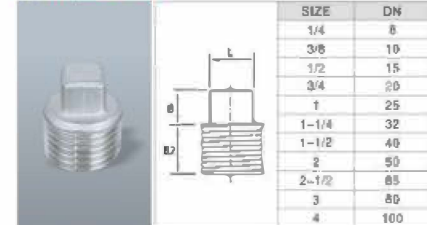

管盖 Round Cap

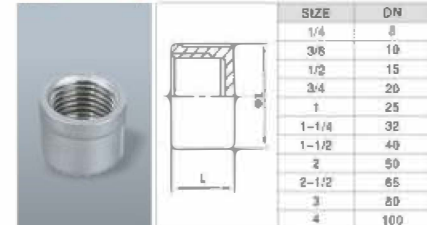



不锈钢丝扣管件系列

Stainless steel threaded pipe fittings series



PROCUREMENT SERVICES FROM

BDFS

BuyDirectFromSuppliers.com

Manufactured in Mexico-China-Brazil-USA-Bahrain

Brent Gilbertson Mobile: 678-361-5559
Managing Partner/Founder Brent@BuyDirectFromSuppliers.com

特点 FEATURE

- 连接形式: 螺纹、软管、堵头
- 材质为: SUS304, SUS316制成
- 管道流量控制: DN8-100及1/4"-4"
- 适用介质: 水、油、气体及与CF8M/CF8适宜的各种腐蚀性介质

- Type: Screwed, Hose, Plug
- Material Quality: SUS304, SUS316
- Size: DN8-100&1/4"-4"
- Applicable Mediums: WOG & Every kind of corrosive mediums suitable for CF8M/CF8

内螺纹活接头 Female Threaded Union

SIZE	DN
1/4	8
3/8	10
1/2	15
3/4	20
1	25
1-1/4	32
1-1/2	40
2	50
2-1/2	65
3	80
4	100

加长单头丝 Lengthen Dan Toubi

SIZE	DN
1/4	8
3/8	10
1/2	15
3/4	20
1	25
1-1/4	32
1-1/2	40
2	50
2-1/2	65
3	80
4	100

内外螺纹活接头 Male/Female Threaded Union

SIZE	DN
1/4	8
3/8	10
1/2	15
3/4	20
1	25
1-1/4	32
1-1/2	40
2	50
2-1/2	65
3	80
4	100

加长外丝 Lengthening outer thread

SIZE	DN
1/4	8
3/8	10
1/2	15
3/4	20
1	25
1-1/4	32
1-1/2	40
2	50
2-1/2	65
3	80
4	100

异型管箍 Reduce Socket Banded

SIZE	DN
1/2	3/4
1/2	1
3/4	1
1/2	1 1/4
3/4	1 1/4
1	1 1/4
1	1 1/2
3/4	1 1/2
1	1 1/2
1/2	2
3/4	2
1	2
1/2	2
1/2	2

皮管接头 Skin pipe joint

SIZE	DN
1/4	8
3/8	10
1/2	15
3/4	20
1	25
1-1/4	32
1-1/2	40
2	50
2-1/2	65
3	80
4	100

抛光管子内丝 Coupling

SIZE	D(φ)
1/8	15
1/4	18
3/8	22
1/2	26
3/4	33.7
1	40
1 1/4	48
1 1/2	55
2	69
2 1/2	85
3	100
4	127

单头丝 Dan Toubi

SIZE	DN
1/4	8
3/8	10
1/2	15
3/4	20
1	25
1-1/4	32
1-1/2	40
2	50
2-1/2	65
3	80
4	100

特点 FEATURE

特点 FEATURE

PROCUREMENT SERVICES FROM

BDFS

BuyDirectFromSuppliers.com

Manufactured in Mexico-China-Brazil-USA-Bahrain

Brent Gilbertson Mobile: 678-361-5559
Managing Partner/Founder Brent@BuyDirectFromSuppliers.com



内螺纹三通 Thread Tee

产品材质(Material): 304, 316等材质
规格(Size): 1/4"-4"
压力等级(Pressure): 2000LB-6000LB



承插焊三通 Socket Weld Tee

产品材质(Material): 304, 316等材质
规格(Size): 1/4"-4"
压力等级(Pressure): 3000LB-9000LB



内外丝90°弯头 90° Street Elbow

产品材质(Material): 304, 316等材质
规格(Size): 1/4"-4"
压力等级(Pressure): 2000LB-6000LB



丝口活接头(角径) Thread Union

产品材质(Material): 304, 316等材质
规格(Size): 1/4"-3"
压力等级(Pressure): 2000LB-6000LB



塞头 Plug

产品材质(Material): 304, 316等
规格(Size): 1/4"-4"
压力等级(Pressure): 2000LB-6000LB



半管接头 Half Nipple

产品材质(Material): 304, 316等材质
规格(Size): 1/4"-4"
压力等级(Pressure): 2000LB-9000LB



补芯 Bushing

产品材质(Material): 304, 316等材质
规格(Size): 1/4"-4"
压力等级(Pressure): 2000LB-6000LB



锻钢螺纹四通 Forged steel Thread Cross

产品材质(Material): A106等材质
规格(Size): 1/4"-4"
压力等级(Pressure): 2000LB-6000LB

Providing you 给你不一样的品质
With unique quality

精良的设计与制造，成就真正的经典，庐威给你不一样的产品质量



PROCUREMENT SERVICES FROM
B D F S

BuyDirectFromSuppliers.com

Manufactured in Mexico-China-Brazil-USA-Bahrain

Brent Gilbertson Mobile: 678-361-5559
Managing Partner/Founder Brent@BuyDirectFromSuppliers.com

1PC、2PC不锈钢内螺纹球阀

1PC、2PC Stainless steel threaded end ball valve

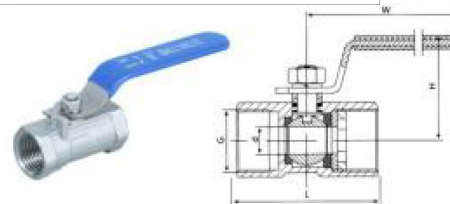

1PC不锈钢内螺纹球阀

特点 FEATURE

1PC结构设计
标准口径
产品规格: 1/4"-4"(DN8-100)
工作压力: 1000PSI
螺纹端可按BSPT, NPT, DIN2999制造

1PC Body
Standard Bore
Size: 1/4"-4"(DN8-100)
Working Pressure: 1000PSI
Threaded End: BSPT, NPT, DIN2999

1PC 材料列表 MATERIAL LIST

No.	部件名称	Part Name	材料Material
1	阀体	Body	WCB CF8M
2	阀盖	Bonnet	WCB CF8M
3	阀座	Seat	RPTFE
4	球	Ball	SS304 SS316
5	密封垫	Seal Gasket	PTFE
6	阀杆密封	Stem seal	PTFE
7	阀杆	Stem	SS316
8	防静电装置	Anti-Static Device	SS304
9	阀杆填料	Stem Packing	PTFE
10	填料压盖	Packing Gland	SS304
11	弹性垫圈	Spring washer	SS304
12	手柄	Handle	SS201

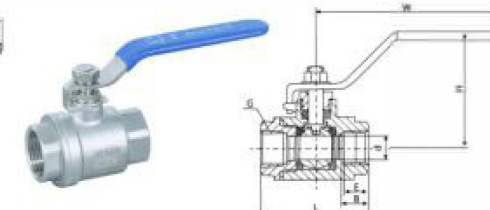

2PC不锈钢内螺纹球阀

特点 FEATURE

2PC结构设计
全通径
产品规格: 1/4"-4"(DN8-100)
工作压力: 1000PSI(1.6MPa)
螺纹端可按BSPT, NPT, DIN2999制造

2PC Body
Full Bore
Size: 1/4"-4"(DN8-100)
Handle With Locking Device
Working Pressure: 1000PSI(1.6MPa)
Threaded End: BSPT, NPT, DIN2999

1PC 尺寸列表 DIMENSION LIST

NPS	DN	d	L	H	W
1/4	8	5	40	22	80
3/8	10	7	45	26	80
1/2	15	9	57	31	88
3/4	20	12	60	34	89
1	25	15	72	38	105
1-1/4	32	20	79	43	105
1-1/2	40	25	85	50	124
2	50	32	101	57	124
2-1/2	65	38	125	89	180
3	80	50	150	102	190
4	100	65	195	120	215

2PC 材料列表 MATERIAL LIST

No.	部件名称	Part Name	材料Material
1	阀体	Body	CF8 CF8M
2	阀盖	Bonnet	CF8 CF8M
3	球	Ball	SS304 SS316
4	阀座	Seat	RPTFE
5	阀杆	Stem	SS304 SS316
6	手柄	Handle	SS201
7	填料	Packing	PTFE
8	密封垫	Seal Gasket	PTFE
9	螺母	Nut	SS304
10	把手	Handle cover	PLASTIC
11	垫圈	Thrust washer	SS304

2PC 尺寸列表 DIMENSION LIST

NPS	DN	d	L	H	W
1/4	8	10	55	42	95
3/8	10	12	55	42	95
1/2	15	15	62	51	108
3/4	20	20	75	58	115
1	25	25	85	77	135
1-1/4	32	32	102	83	150
1-1/2	40	38	108	97	175
2	50	50	124	106	190
2-1/2	65	65	163	122	220
3	80	80	185	133	250
4	100	100	225	162	320

3PC不锈钢内螺纹、对焊球阀

3PC Stainless steel threaded end, butt welding ball valve

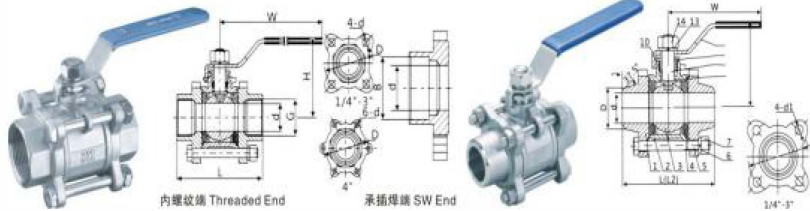

3PC不锈钢内螺纹球阀

3PC不锈钢对焊球阀

特点 FEATURE

3PC结构设计
全通径
产品规格: 1/4"-4"
工作压力: 1000PSI
螺纹端可按BSPT, NPT, DIN2999制造
可选带加长承插焊端口
可选带锁手柄

3PC Body
Full Bore
Size: 1/4"-4"
Working Pressure: 1000PSI
Threaded End: BSPT, NPT, DIN2999
Female Threaded or Socket Welded End
(Optional) Locking device Handle

3PC内螺纹 材料列表 MATERIAL LIST

No.	部件名称	Part Name	材料Material
1	阀体	Body	CF8M
2	阀盖	Bonnet	CF8M
3	阀座	Seat	RPTFE
4	球	Ball	SS316
5	密封垫	Gasket	PTFE
6	阀杆密封	Stem seal	PTFE
7	阀杆	Stem	SS316
8	防静电装置	Anti-Static Device	SS304
9	阀杆填料	Stem Packing	PTFE
10	填料压盖	Packing Gland	SS304
11	弹性垫圈	Spring Washer	SS304
12	手柄	Handle	SS304
13	螺母	Stem Nut	SS304

3PC对焊 材料列表 MATERIAL LIST

No.	部件名称	Part Name	材料Material
1	阀盖	Bonnet	CF8M
2	阀体	Body	CF8M
3	球	Ball	SS316
4	阀座	Seat	RPTFE
5	螺栓	Bolt	B8
6	垫片	Gasket	SS301
7	螺母	Stem Nut	B8
8	阀杆密封	Stem Seal	PTFE
9	阀杆	Stem	SS316
10	填料	Packing	PTFE
11	填料压盖	Packing Gland	SS304
12	手柄	Handle	SS304
13	弹性垫圈	Spring Washer	SS301
14	螺母	Stem Nut	SS304



Manufactured in Mexico-China-Brazil-USA-Bahrain

Brent Gilbertson Managing Partner/Founder
Mobile: 678-361-5559
Brent@BuyDirectFromSuppliers.com



Manufactured in Mexico-China-Brazil-USA-Bahrain

Brent Gilbertson Managing Partner/Founder
Mobile: 678-361-5559
Brent@BuyDirectFromSuppliers.com

广式内螺纹球阀 Bar stock ball valve with internal thread 不锈钢内螺纹三通球阀 Stainless steel threaded end three-way ball valve

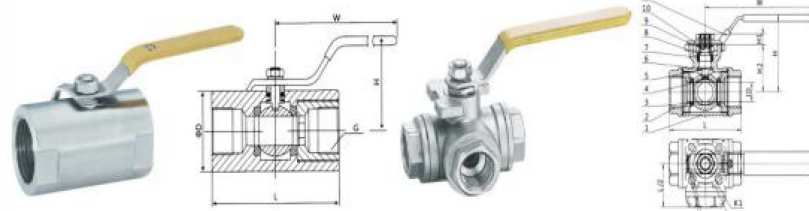

广式内螺纹球阀

不锈钢内螺纹三通球阀

特点 FEATURE

工作压力: 0-1.6-6.4MPa(1000PSI)
标准通径
产品规格: 1/2"-2"
阀体不锈钢阀体
适用温度: <150°C(PPL<300°C)
适用介质: 水、空气、油品等
螺纹端可按BSPT, NPT制造

Working Pressure: 0-1.6-6.4MPa(1000PSI)
Standard Bore
Size: 1/2"-2"
Body made of Forged Steel
Applicable Temperature: <150°C(PPL<300°C)
Applicable Media: Water, Gas, Oil
Threaded Standard: BSPT, NPT

广式内螺纹球阀 材料列表 MATERIAL LIST

No.	部件名称	Part Name	材料Material
1	阀体	Body	A105 1Cr18Ni9Ti SS304 SS316
2	球、杆	Ball, Stem	SS304 SS304 SS304 SS316
3	密封	Seal	PTFE, RPTFE, PPL
4	手柄	Handle	SS304

不锈钢内螺纹三通球阀 材料列表 MATERIAL LIST

No.	部件名称	Part Name	材料Material
1	阀体	Body	CF8M CF8 WCB
2	阀盖	Bonnet	CF8M CF8 WCB
3	阀座	Seat	PTFE/PTFE PTFE/PTFE PTFE
4	球	Ball	316 SS304 SS304
5	阀杆	Stem	316 SS304 SS304
6	弹性垫圈	Thrust Washer	PTFE PTFE PTFE
7	填料	Packing	PTFE PTFE PTFE
8	填料压盖	Packing Gland	SS301 SS301 SS302
9	六角螺母	Hex Nut	SS301 SS301 SS302
10	手柄	Handle	SS301 SS301 SS302
11	锁片	Lock	SS301 SS301 SS302

特点 FEATURE

标准通径设计
阀体通径: L-通或T-通
工作压力: 1000PSI(PN16)
工作温度: -10°C-250°C(-4°F-482°F)
1/4"-3"
硅溶取阀体及阀盖, 防吹出阀杆
手柄可选带锁装置: ISO5211平台
驱动方式: 手动、气动、电动
螺纹端可按: NPT/BSPT/BSPP, G/BSPT/BSPP

Standard Port: L-Port & T-Port
W.P.: 1000PSI(PN16)
W.T.: -20°C-250°C(-4°F-482°F)
1/4"-3"
Investment Casting Body & Cap
Blow-Off Proof Stem
Locking Device: ISO5211 Mounted Pad
Type of Drive: Manual, Pneumatic, Electric
Thread End: ANSI B1.20.1(NPT)/
ISO228/1 & DIN259(G)/DIN2999 & BS21(BSPT)

广式内螺纹球阀 尺寸列表 DIMENSION LIST

NPS	d	D	L	W	H
1/2	11	32	60	110	58
3/4	13	38	67	110	62
1	17	45	73	110	68
1-1/4	23	53	90	150	75
1-1/2	25	61	97	150	83
2	32	73	112	160	90

不锈钢内螺纹三通球阀 尺寸列表 DIMENSION LIST

NPS	DNP	ID	L	H	W	H1	H2	K1	K2	d1	d2	F
1/2	15	12	71	71	145	8.5	37	36	42	6	6	9
3/4	20	15	81	74	145	14	40	36	42	6	6	9
1	25	17	90	83	155	13	46	42	50	6	7	11
1-1/4	32	25	125	94	155	11	57	42	50	6	7	11
1-1/2	40	32	138	113	196	18.5	70	50	70	7	9	14
2	50	38	152	120	196	18.5	77	50	70	7	9	14

意大利超薄型球阀

Italy-type wafer ball valve

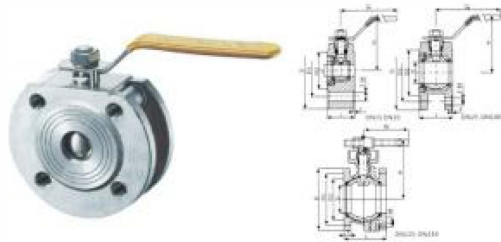

意大利超薄型球阀

特点 FEATURE

一体式结构设计(DN125以上为分体结构)
全通径流量
产品规格从DN15-DN250
结构长度符合SYF012-90标准
法兰密封符合GB/T9113制造
阀门密封和试验符合API586
手柄或蜗轮传动

1PC Body(2PC Body for DN125and Over)
Full Bore
Size: 1/2"to10"
Face to Face:BB/T3113 Q/SYF012-96
Flanged Standard ANSI B 16.5
Checked and Tested API599
Handle or Gear operated

意大利超薄型球阀 材料列表 MATERIAL LIST

No.	部件名称	Part Name	材料Material
1	阀体	Body	WCB CF8M
2	阀盖	Bonnet	WCB CF8M
3	阀座	Seat	PTFE
4	球	Ball	SS304 SS316
5	密封圈	Seal Ring	PTFE
6	阀杆密封	Stem Seal	PTFE
7	阀杆	Stem	SS316
8	防静电装置	Anti-Static Device	SS304
9	阀杆填料	Stem Packing	PTFE
10	填料压盖	Packing	SS304
11	弹性垫圈	Spring Washer	SS304
12	手柄	Handle	SS304
13	螺母	Stem Nut	SS304

气动角座阀 参数 Data

接口(英寸)	内径(mm)	KV值	最大工作压力	最小控制压力	执行机构	流向	控制方式
Interface	Inner Bore	(m ³ /h)	(bar/Max working pressure)	(bar/Min Control pressure)	Actuator	Flow Direction	Control Way
G3/4	20.0	8.0	0-16	2.7	50	阀座上方 Above the seat	
G1	25.0	19.0	0-16	2.0	63		
G1 1/4	32.0	27.5	0-16	2.0	83		
G1 1/2	40.0	42.0	0-18	2.0	83		
G2	50.0	52.0	0-16	2.0	80		
G2 1/2	65.0	77.0	0-14	1.6	100		

PROCUREMENT SERVICES FROM
B D F S
BuyDirectFromSuppliers.com

Manufactured in Mexico-China-Brazil-USA-Bahrain

Brent Gilbertson Managing Partner/Founder
Mobile: 678-361-5559
Brent@BuyDirectFromSuppliers.com

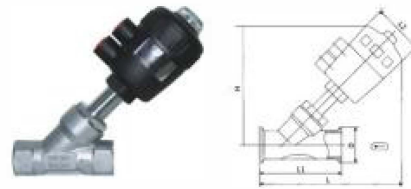

气动角座阀

特点 FEATURE

压力范围: 0-16bar
介质温度: -10°C→+180°C
环境温度: -10°C→+60°C
规格: DN15-DN65, 1/2"-2 1/2"
阀体材料: 不锈钢, CF8/304, CF8M/316
密封材料: 聚四氟乙烯
执行机构外壳: 聚醚醚酮
介质: 中性气体、空气、水、蒸汽
制造标准: 3A, ISO, DIN, IDF

Pressure range: 0-16bar
Medium temperature: -10°C→+180°C
Environmental temperature: -10°C→+60°C
Specification: DN15-DN65, 1/2"-2 1/2"
Body material: Stainless steel, CF8/304, CF8M/316
Sealing material: PTFE Actuator material: PA
Medium: Neutral gas, air, water, Vapor
Manufacture standard: 3A, ISO, DIN, IDF

意大利超薄型球阀 尺寸列表 DIMENSION LIST

1.6MPa													2.5MPa												
DN	d	D	D1	D2	F	L	W	H	3-Φ	D1	D2	F	L	W	H	3-Φ	D1	D2	F	L	W	H			
10	19	95	60	46	-	2	36	100	00	4	10	95	05	40	2	-	35	120	85	4	10	95	05		
20	30	100	70	56	-	2	38	120	65	4	12	109	75	56	2	-	38	120	71	4	12	109	75		
25	35	110	80	66	-	2	42	140	70	4	14	119	85	66	2	10	42	140	78	4	14	119	85		
32	32	135	100	75	16	2	52	170	90	4	16	136	100	75	3	18	52	170	90	4	16	136	100		
40	38	145	110	85	18	2	62	200	95	4	18	145	110	85	3	15	62	200	105	4	18	145	110		
50	45.5	160	125	100	18	2	72	240	120	4	18	160	125	100	3	15	72	240	120	4	18	160	125		
65	58	185	145	120	20	2	90	280	130	4	18	180	145	120	3	20	90	280	145	4	18	180	145		
80	73	195	160	135	22	3	110	320	145	4	18	195	160	135	3	22	110	320	170	4	18	195	160		
100	83	215	180	155	24	3	130	400	160	4	18	210	180	155	3	24	130	400	180	4	18	210	180		
125	120	245	210	185	28	3	200	500	177	4	18	230	210	185	3	28	200	450	205	4	18	230	210		
150	145	280	240	210	28	3	235	700	237	4	18	260	250	210	3	28	235	500	225	4	18	260	250		
200	190	335	295	265	30	3	275	790	280	4	18	310	310	275	3	30	275	600	240	4	18	310	310		

气动角座阀 尺寸列表 DIMENSION LIST

DN	L	L1	L1	L2	H	D	执行机构 Actuator
15	180	120	64	64	137	60.5	φ50
20	185	140	64	64	145	50.5	φ50
25	210	160	80	80	173	50.5	φ63
32	240	176	80	80	210	50.5	φ63
40	250	190	80	80	260	50.5	φ63
50	330	210	100	100	301	64	φ80

PROCUREMENT SERVICES FROM
B D F S
BuyDirectFromSuppliers.com

Manufactured in Mexico-China-Brazil-USA-Bahrain

Brent Gilbertson Managing Partner/Founder
Mobile: 678-361-5559
Brent@BuyDirectFromSuppliers.com



不锈钢内螺纹Y型过滤器

特点 FEATURE

Y型结构设计
全通径流量
产品规格从1/4"到2"
工作压力: 400/800PSI
端盖端可按BSPT, NPT, DIN2999制造

Y-type Body
Full Bore
Size 1/4"to2"
Working Pressure: 400/800PSI
Threaded End: BSPT, NPT, DIN2999

不锈钢内螺纹Y型过滤器 材料列表 MATERIAL LIST

No.	部件名称	Part Name	材料Material	QTY
1	阀体	Body	CF8 CF8M	1
2	阀盖	Bonnet	CF8 CF8M	1
3	过滤网	Gauze Filter	SS316 SS316	1-2
4	垫片	Gasket	PTFE PTFE	1
5	密封圈	Seal Ring	PTFE PTFE	1
6	螺塞	Plug	SS304 SS316	1

旋启式内螺纹止回阀 材料列表 MATERIAL LIST

No.	部件名称	Part Name	材料Material
1	阀体	Body	CF8M
2	阀瓣	Disc	CF8M
3	销轴	Pin	SS304
4	密封圈	Seal Ring	PTFE
5	阀盖	Bonnet	CF8

不锈钢内螺纹Y型过滤器
Stainless steel threaded end Y-strainer
旋启式内螺纹止回阀
Stainless steel threaded end swing check valve

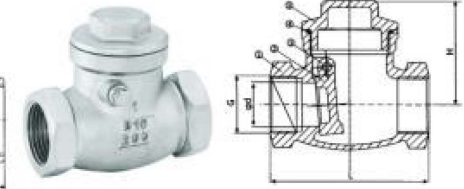

旋启式内螺纹止回阀

特点 FEATURE

全通径流量
产品规格从1/4"-3"
工作压力: 200PSI/600PSI
内螺纹端可按BSPT, NPT, DIN2999制造

Full Bore
Size 1/4"to2"
Working Pressure: 200PSI/600PSI
Female Threaded End: BSPT, NPT, DIN2999

不锈钢内螺纹Y型过滤器 尺寸列表 DIMENSION LIST

NPS	400PSI			800PSI		
	d	L	H	d	L	H
1/4	9	50	34.3	9	50	34.3
3/8	9	50	34.3	9	50	34.3
1/2	15	60	41	14	60	41
3/4	20	75	51	18	75	51.83
1	25	90	60	22	90	62.3
1-1/4	32	100	70	28	100	71.3
1-1/2	40	119	80	38	120	82.3
2	50	139	95	48	148	99.3

旋启式内螺纹止回阀 尺寸列表 DIMENSION LIST

NPS	d	L	H
1/4	6	58	36
3/8	10	58	36
1/2	15	66	40
3/4	20	80	54
1	25	90	59
1-1/4	32	105	62.5
1-1/4	38	120	73
2	50	140	85

不锈钢内螺纹闸阀
Stainless steel threaded end gate valve
不锈钢内螺纹截止阀
Stainless steel threaded end globe valve



PROCUREMENT SERVICES FROM
BDFS
BuyDirectFromSuppliers.com
Manufactured in Mexico-China-Brazil-USA-Bahrain
Brent Gilbertson Mobile: 678-361-5559
Managing Partner/Founder Brent@BuyDirectFromSuppliers.com

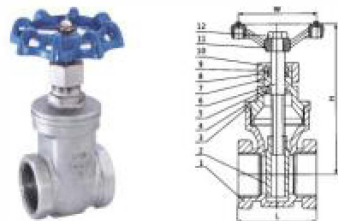

不锈钢内螺纹闸阀

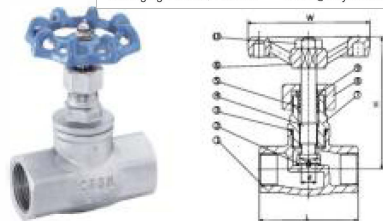

不锈钢内螺纹截止阀

特点 FEATURE

全通径流量
产品规格从1/2"-3"
工作压力: 200PSI
内螺纹端可按BSPT, NPT, DIN2999制造

Full Bore
Size 1/2"to2"
Working Pressure:200PSI
Female Threaded End:BSPT,NPT,DIN2999

不锈钢内螺纹闸阀 材料列表 MATERIAL LIST

No.	部件名称	Part Name	材料Material
1	阀体	Body	CF8M CF8
2	阀板	Disc	CF8M CF8
3	密封圈	Seal Ring	SS316 SS316
4	卡簧	Snap Spring	316
5	弹垫	Washer	PTFE
6	杆	Stem	CF8M CF8
7	阀盖	Bonnet	SS316 SS304
8	填料	PTFE	PTFE
9	垫片	Gasket	PTFE
10	压盖螺母	Gland Nut	SS316
11	手轮	Handwheel	HT(C.R.)
12	螺母	Nut	SS316

不锈钢内螺纹截止阀 材料列表 MATERIAL LIST

No.	部件名称	Part Name	材料Material
1	阀体	Body	CF8M CF8
2	阀瓣	Disc	CF8M CF8
3	密封圈	Seal Ring	SS316 SS316
4	阀杆	Stem	SS316 SS304
5	填料	PTFE	PTFE
6	手轮	Handwheel	HT(C.R.)
7	阀盖	Bonnet	CF8M CF8
8	压盖螺母	Gland Nut	SS316
9	填料压盖	Packing Gasket	SS316
10	螺母	Nut	SS316

特点 FEATURE

全通径流量
产品规格从1/2"到2"
工作压力: 200PSI
内螺纹端可按BSPT, NPT, DIN2999制造

Full Bore
Size 1/2"to2"
Working Pressure:200PSI
Female Threaded End:BSPT,NPT,DIN2999

不锈钢内螺纹闸阀 尺寸列表 DIMENSION LIST

NPS	d	H	L	W
1/2	15	105	50	78
3/4	20	108	60	70
1	25	135	65	80
1-1/4	32	145	75	80
1-1/2	40	155	85	90
2	50	185	95	100

不锈钢内螺纹截止阀 尺寸列表 DIMENSION LIST

NPS	d	H	L	W
1/2	15	105	50	70
3/4	20	108	60	70
1	25	135	65	80
1-1/4	32	145	75	80
1-1/2	40	155	85	90
2	50	185	95	100

PROCUREMENT SERVICES FROM
BDFS
BuyDirectFromSuppliers.com
Manufactured in Mexico-China-Brazil-USA-Bahrain

Brent Gilbertson Mobile: 678-361-5559
Managing Partner/Founder Brent@BuyDirectFromSuppliers.com



Q41 不锈钢法兰球阀
Stainless steel flanged ball valve

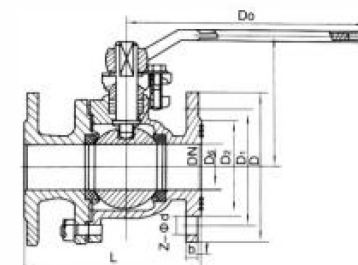

法兰球阀特点

产品规格: DN15-200
工作压力: 1.6/2.5/4.0/6.4MPa
工作温度: <150°C(PPL<300°C)
法兰标准按JB,也可按美标

FLANGE BALL VALVE FEATURES

Size:DN15-200
Working Pressure:1.6/2.5/4.0/6.4MPa
Working Temperature<150°C(PPL<300°C)
Flange Standard JB79 or ANSI B16.25

主要尺寸 MAIN DIMENSION

DN	L	D	D1	D2	H	B-f	Z-φd	DN
40	180	145	110	85	150	16-3	16-3	240
50	200	160	124	100	160	16-3	16-3	240
65	220	180	145	120	185	18-3	18-3	320
80	250	195	160	135	215	20-3	20-3	380
100	280	215	180	155	250	20-3	20-3	400
125	320	245	210	185	280	22-3	22-3	500
150	360	280	240	210	320	24-3	24-3	600
200	480	335	295	265	370	26-3	26-3	800

主要零件材料 MATERIAL FOR MAIN PARTS

零件名称 Part name	材料 Material	
	Q41F-16P -25P, 40P	Q41F-16R -25R, 40R
阀体 Body	格纹钛钢 Cr Ni Ti	格纹钛钢 Cr Ni Mo Steel
球体 Ball		
阀杆 Stem		
密封圈 Seal ring	聚四氟乙烯 Poly tetrafluoroethylene	
扳手 Hand wheel	碳钢 Carbon steel	

主要尺寸 MAIN DIMENSIONS

型号 type	公称通径 (DN) Nominal Diameter	尺寸(mm) Dimensions							
		L	D	D1	D2	H	b-f	Z-φd	Da
Q41F-16P (R)	15	130	95	65	45	60	14-2	4-14	108
	20	140	105	75	55	84	14-2	4-14	120
	25	150	115	88	65	90	16-2	4-14	165
	32	165	135	100	78	105	16-2	4-18	180
	40	180	145	110	85	150	16-3	4-18	240
	50	200	160	125	100	190	16-3	4-18	240
	65	220	180	145	120	195	18-3	4-18	320
	80	250	195	160	135	215	20-3	8-18	350
	100	280	215	180	165	250	20-3	8-18	400
	125	320	245	210	185	280	22-3	8-18	500
	150	360	280	240	210	320	24-3	8-23	600
	200	400	335	295	265	370	26-3	12-23	800



特点 FEATURE

连接形式: 螺纹、法兰、焊接、卡套、快换
 材质为: SUS304、SUS316制成
 管道质量控制: DN15-150及1/2"-6"
 适用介质: 水、油、气体及与CF8M/CF8适宜的各种腐蚀性介质

Type: Screwed, Flanged, Welding
 adlus table joint, Quick Coupling
 Material Quality: SUS304, SUS316
 Size: DN15-150& 1/2"-6"
 Applicable Mediums: WOG & Every kind of corrosive
 mediums suitable for CF8M/CF8

TYPE:A ADAPTOR FEMALE

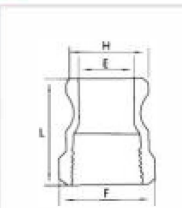

SIZE	Inch	1/2	3/4	1	1-1/4	2	2-1/2	3	4	6
E	mm	15	20	25	32	50	65	80	100	150
H		14.3	21	23.8	30.8	46	58	73.2	98.2	149
F		29.3	39.2	43.8	51.9	74.7	82.3	87.8	126.8	191
L		24.3	32	38.8	45.5	63	78.9	91.5	119.5	175.9
		41.3	39	48.5	52.5	61.7	68	70	74.6	85

TYPE:B COUPLER MALE

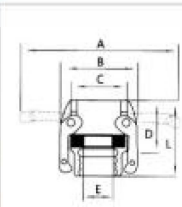

SIZE	Inch	1/2	3/4	1	1-1/4	1-1/2	2	2-1/2	3	4	6
A	mm	15	20	25	32	40	50	65	80	100	150
B		68.4	116	125	181	189	199	210	254	282	409
C		39.9	53.3	60.9	82.6	90.3	99.8	112.4	137.6	166.6	255
D		34.9	41	47	58	65	75	90	108	140	198
E		32.5	32	39	44.5	45.0	50.0	54.3	55.5	55.5	73
L		14.3	19.0	25.0	36.6	39.0	50.8	63.0	76.2	100.8	146
		49.2	51	58	87.2	65.7	75.4	83.3	86.6	88.8	116

TYPE:C COUPLER FEMALE

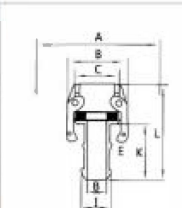

SIZE	Inch	1/2	3/4	1	1-1/4	1-1/2	2	2-1/2	3	4	6
A	mm	15	20	25	32	40	50	65	80	100	150
B		68.4	116	125	181	189	199	210	254	282	409
C		39.9	53.3	60.9	82.6	90.3	99.8	112.4	137.6	166.6	255
D		34.9	41	47	58	65	75	91	108	140	198
E		8.0	13.8	18.8	25.9	32.3	44.5	56.7	68	83.4	142
K		14.0	21.0	27.0	33.7	40.1	52.7	66.3	79	104.4	157
L		41.3	51	57	59	61	70	79	102	108	146
		84.9	82.8	95.2	102.5	104.0	129	142.3	157.1	163.5	214

TYPE:D COUPLER FEMALE

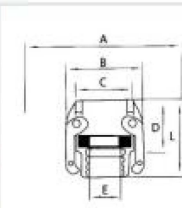

SIZE	Inch	1/2	3/4	1	1-1/4	1-1/2	2	2-1/2	3	4	6
A	mm	15	20	25	32	40	50	65	80	100	150
B		68.4	116	125	181	189	199	210	254	282	409
C		39.9	53.3	60.9	82.6	90.3	99.8	112.4	137.6	166.6	255
D		34.9	41	47	58	65	75	91	108	140	198
E		32.5	32	39	44.5	45.0	50.0	54.3	55.5	55.5	74
L		14.3	21	25.0	34.9	39.0	50.8	63.0	76.2	100.8	148
		49.2	51	61.8	67.5	67	72.2	83.3	86.5	88.8	114

不锈钢快速接头系列
Stainless steel quick
connector series



Brent Gilbertson
Managing Partner/Founder

Type: Screwed, Flanged, Welding
adjux table joint, Quick Coupling
Material Quality: SUS304, SUS316
Size: DN15-150&1/2"-6"
Applicable Mediums: WOG & Every kind of corrosive
mediums suitable for CF8M/CF8

特点 FEATURE

连接形式: 螺纹、法兰、带颈、卡套、快接
材质为: SUS304、SUS316制成
管道流量控制: DN15-150及1/2"-6"
适用介质: 水、油、气体及与CF8M/CF8适宜的各种腐蚀性介质

TYPE:E ADAPTOR HSAE SHANK



SIZE	Inch	1/2	3/4	1	1-1/4	1-1/2	2	2-1/2	3	4	6
	mm	15	20	25	32	40	50	65	80	100	150
E		8.0	13.8	19.8	25.8	32.3	44.5	56.7	68	93.4	142
H		24.3	32	38.6	45.5	53.4	63	75.9	91.5	119.5	175.9
I		14.6	21.0	27.0	33.7	40.1	52.7	66.3	79	104.4	157
J		30.2	35.0	38.0	48.0	55.4	65.3	79.5	93.5	121.5	187
K		41.3	51	60	57	60	70	80	100	106	146
L		86.5	86.3	105.8	109.5	113	138.5	149.5	166.6	174.5	224

TYPE:F ADAPTOR MALE



SIZE	Inch	1/2	3/4	1	1-1/4	1-1/2	2	2-1/2	3	4	6
	mm	15	20	25	32	40	50	65	80	100	150
D		34.1	38.0	48.5	52.5	54	61.7	68	70	74.5	83
E		14.3	21.3	23.8	30.8	38.5	46.7	56	73.2	98.2	149
F		29.3	38.2	43.8	51.9	60.4	74.7	82.3	97.8	126.8	196
H		24.3	32	38.6	45.5	53.4	63	75.9	91.5	119.5	175.9
L		48.8	58	67.5	73.2	74.7	87.1	79	101	107.9	127

TYPE:DC DUST CAP

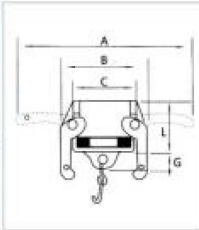

SIZE	Inch	1/2	3/4	1	1-1/4	1-1/2	2	2-1/2	3	4	6
	mm	15	20	25	32	40	50	65	80	100	150
A		68.4	116	125	181	189	199	68	70	282	409
B		39.9	83.3	60.8	82.6	90.3	99.8	58	73.2	165.6	255
C		34.9	41	47	58	65	75	82.3	97.8	140	198
G		9.5	10	12	11	12	12	75.9	91.5	12	16
L		32.5	34.0	41.0	46.5	53.2	53.2	79	101	80.6	68

TYPE:DP DUDST PLUG



SIZE	Inch	1/2	3/4	1	1-1/4	1-1/2	2	2-1/2	3	4	6
	mm	15	20	25	32	40	50	65	80	100	150
G		9.5	12	13	14	16	19	11	11	13	16
H		24.3	32	36.5	45.5	53.4	63	75.9	91.5	119.5	175.9
L		26	27.5	36.8	42	44.0	50.8	53	55.0	62.8	60

Classic 经典, 永恒的品质
Eternal quality

您的要求, 是我们对产品质量细节的标准。



对焊弯头尺寸
Butt welding elbow size



Brent Gilbertson
Managing Partner/Founder
Mobile: 678-361-5559
Brent@BuyDirectFromSuppliers.com

GB/T12459-2005, GB/T13401-92

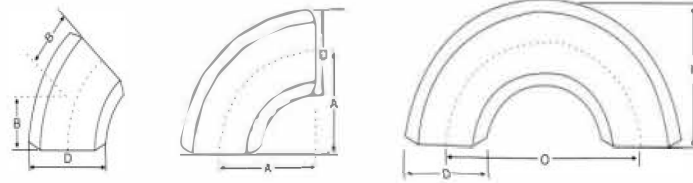

45° 弯头 45° Elbow 90° 弯头 90° Elbow 180° 弯头 180° Elbow

mm

公称直径 Nominal Pipe size DN	端部外径 Outside Diameter at Bevel D		中心至端面 Center to End			中心至中心 Center to Center		背面至端面 Back to Faces	
	A系列 Series A	B系列 Series B	45°弯头 Elbows		90°弯头 Elbows	180°弯头 Return		180°弯头 Return	
			B	A					
	长半径 Long Radius	长半径 Long Radius	短半径 Short Radius	长半径 Long Radius	短半径 Short Radius	长半径 Long Radius	短半径 Short Radius	长半径 Long Radius	短半径 Short Radius
15	21.3	18	16	38	-	76	-	48	-
20	26.9	25	16	38	-	76	-	51	-
25	33.7	32	16	38	25	76	51	56	41
32	42.4	38	20	48	32	95	64	70	52
40	48.3	45	24	57	38	114	76	83	62
50	60.3	57	32	76	51	152	102	106	81
65	73	76	40	95	64	191	127	132	100
80	88.9	89	47	114	76	229	152	159	121
90	101.6	-	55	133	89	267	178	184	140
100	114.3	108	63	152	102	305	203	210	159
125	141.3	133	79	190	127	381	254	262	197
150	168.3	159	95	229	152	457	305	313	237
200	219.1	219	126	305	203	610	406	414	313
250	273.0	273	158	381	254	762	508	518	391
300	323.9	325	189	457	305	914	610	619	467
350	355.6	377	221	533	356	1067	711	711	533
400	406.4	426	253	610	406	1219	813	813	610
450	457	478	284	686	457	1372	914	914	686
500	508	529	316	762	508	1524	1016	1016	762
550	559	-	347	838	559	1676	1118	1118	838
600	610	630	379	914	610	1829	1219	1219	914
650	660	-	410	991	660				
700	711	720	442	1067	711				
750	762	-	473	1143	762				
800	813	820	505	1219	813				
850	864	-	537	1295	864				
900	914	920	568	1372	914				
950	965	-	600	1448	965				
1000	1016	1020	631	1524	1016				
1050	1067	-	663	1600	1067				
1100	1118	1120	694	1676	1118				
1150	1168	-	726	1753	1168				
1200	1220	1220	758	1829	1219				

注: GB/T12459-2005 尺寸范围
DN15-800
GB/T13401-92 尺寸范围
DN350-1200

Note: GB/T12459-2005 size range is
DN15-800
GB/T13401-92 size range is
DN350-1200

GB/T12459-2005, GB/T13401-92

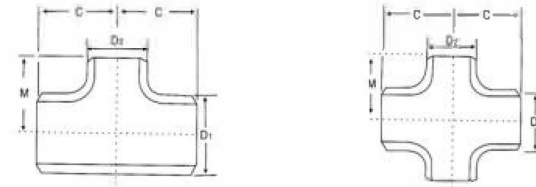

异径三通
Reducing Outlet Tee

异径四通
Reducing Outlet Cross

mm

公称直径 Nominal Pipe size DN	端部外径 Outside Diameter at Bevel				中心至端面 Center to End	
	D1		D2		C	M
	A系列 Series A	B系列 Series B	A系列 Series A	B系列 Series B		
20x15	26.9	25	21.3	18	29	29
25x20	33.7	32	26.9	25	38	38
25x15	33.7	32	21.3	18	38	38
32x25	42.4	38	33.7	32	48	48
32x20	42.4	38	26.9	25	48	48
32x15	42.4	38	21.3	18	48	48
40x32	48.3	45	42.4	38	57	57
40x25	48.3	45	33.7	32	57	57
40x20	48.3	45	26.9	25	57	57
40x15	48.3	45	21.3	18	57	57
50x40	60.3	57	48.3	45	64	60
50x32	60.3	57	42.4	38	64	57
50x25	60.3	57	33.7	32	64	57
50x20	60.3	57	26.9	25	64	44
65x50	73	76	60.3	57	76	70
65x40	73	76	48.3	45	76	67
65x32	73	76	42.4	38	76	64
65x25	73	76	33.7	32	76	57
80x65	88.9	89	73	76	86	83
80x50	88.9	89	60.3	57	86	76
80x40	88.9	89	48.3	45	86	73
80x32	88.9	89	42.4	38	86	70
90x60	101.6	-	68.9	-	95	92
90x50	101.6	-	73	-	95	89
90x40	101.6	-	60.3	-	95	83
90x30	101.6	-	48.3	-	95	79

公称直径 Nominal Pipe size DN	端部外径 Outside Diameter at Bevel				中心至端面 Center to End	
	D1		D2		C	M
	A系列 Series A	B系列 Series B	A系列 Series A	B系列 Series B		
100x90	114.3	-	101.6	-	105	102
100x80	114.3	108	88.9	89	105	98
100x5	114.3	108	73	76	105	95
100x50	114.3	108	60.3	57	105	89
100x40	114.3	108	48.3	45	105	86
125x100	141.3	133	114.3	108	124	117
125x90	141.3	-	101.6	-	124	114
125x80	141.3	133	88.9	89	124	111
125x65	141.3	133	73	76	124	108
125x50	141.3	133	60.3	57	124	105
150x125	168.3	159	139.7	133	143	137
150x100	168.3	159	114.3	108	143	130
150x90	168.3	-	101.6	-	143	127
150x80	168.3	159	88.9	89	143	124
150x65	168.3	159	73	76	143	121
200x150	219.1	219	168.3	159	178	168
200x125	219.1	219	139.7	133	178	162
200x100	219.1	219	114.3	108	178	156
200x90	219.1	219	101.6	-	178	152
250x200	273.0	273	219.1	219	216	208
250x150	273.0	273	168.3	159	216	194
200x125	273.0	273	139.7	133	216	191
200x100	273.0	273	114.3	108	216	184
300x250	323.9	325	273.0	273	254	241
300x200	323.9	325	219.1	219	254	229
300x150	323.9	325	168.3	159	254	219

卫生级阀门管件系列
Sanitary valve series



Brent Gilbertson
Managing Partner/Founder Brent@BuyDirectFromSuppliers.com

特点 FEATURE

连接形式: 焊接式、快装式、螺纹式
材质为: SUS304、SUS316L制成
管道流量控制: DN25-DN150及1"-6"
应用于不锈钢管路系统

Type: Welded, Quick-install, Threaded
Material: quality-SUS304, SUS316L
Flux domination of pipeline
Size: DN25-DN150 & 1"-6"
Applied to the stainless steel pipeline system

快装弯头 Clamp

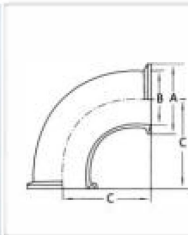

SIZE	φ	A	B	C
1"	25.4	50.5(34)	22.4	55
1 1/4"	31.8	50.5	28.8	60
1 1/2"	38.1	50.5	35.1	70
2"	50.8	64	47.8	82
2 1/2"	63.5	77.5	59.5	105
3"	76.2	91	72.2	110
3 1/2"	88.9	106	84.9	125
4"	101.6	119	97.6	148

快装三通 Clamp/tee

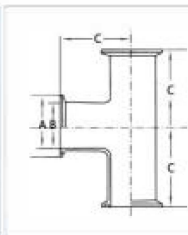

SIZE	A	B	C
1"	50.5(34)	22.4	55
1 1/4"	50.5	28.8	60
1 1/2"	50.5	35.1	70
2"	64	47.8	82
2 1/2"	77.5	59.5	105
3"	91	72.2	110
3 1/2"	106	84.9	125
4"	119	97.6	148

焊接弯头 Welded elbow

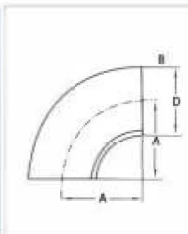

SIZE	A	D
1"	33.5	25.4
1 1/4"	38	31.8
1 1/2"	48.5	38.1
2"	60.5	50.8
2 1/2"	80.5	63.5
3"	88.5	76.2
3 1/2"	103.5	89.9
4"	127	101.6
5"	175	133
6"	214	159

焊接三通 Welded tee

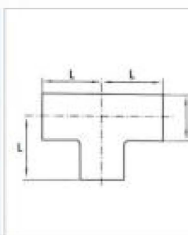

公称直径	L	D
10	28	12
15	35	18
20	40	22
25	50	28
32	55	34
40	60	40
50	70	52
65	80	70
80	90	85
100	100	104
125	187	129
150	225	154

特点 FEATURE

连接形式: 焊接式、快装式、螺纹式
材质为: SUS304、SUS316制成
管道流量控制: DN15-150及1"-6"
应用于不锈钢管路系统

Type: Welded, Clamp, Threaded
Material: SUS304, SUS316L
Flux domination of pipeline
Size: DN25-DN150 & 1"-6"
Applied to the stainless steel pipeline system

快装蝶阀 Clamp butterfly valve

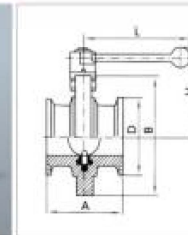

(工业标准有: ISO, DIN, IDF, 3A, SMS等)

规格(ISO)	A	B	D	L	H
20	66	76	50.5	130	82
25	86	78	50.5	130	82
32	68	76	50.5	130	82
38	70	88	50.5	130	86
51	78	102	64	140	96
63	98	115	77.5	150	103
76	98	128	91	150	110
89	102	138	106	170	116
102	106	154	119	170	122
108	106	159	110	170	125
133	140	185	145	190	138
159	268	215	172	190	153

三片式蝶阀 Three-pieces butterfly valve

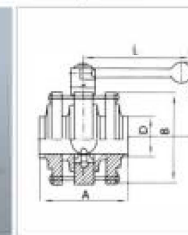

规格(ISO)	A	B	D	L	H
28	100	76	19.05	130	82
25	100	78	25.4	130	82
32	100	78	31.8	130	82
38	100	88	38.1	130	86
51	104	102	50.8	140	96
63	112	115	63.5	150	103
76	112	128	76.1	150	110
89	120	138	88.9	170	115
102	128	154	101.6	170	122
108	128	159	108	170	125
133	168	185	133	190	138
159	180	215	159	190	153

三通式快装手动球阀 Three-way Type Clamp Ball Valve

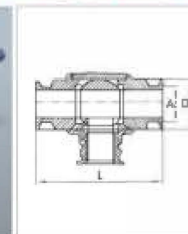

SIZE	A	D	B	L
3/4"	19	50.5	47.5	95
1"	25.4	50.5	60	120
1 1/4"	32	50.5	65	130
1 1/2"	38	50.5	70	140
2"	51	64	85	170
2 1/2"	63.5	77.5	85	190
3"	76.3	91	105	210
3 1/2"	89	106	110	220
4"	101.6	119	120	240

隔膜阀 Diaphragm valve

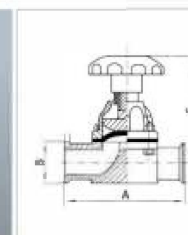

规格(DN)	A	B	L
15	108	34	88/98
20	118	50.5	91/102
25	127	50.5	118/123
32	146	50.5	128/136
40	159	50.5	138/159
50	191	64	159/186



PROCUREMENT SERVICES FROM

B D F S

BuyDirectFromSuppliers.com

Manufactured in Mexico-China-Brazil-USA-Bahrain

Brent Gilbertson

Mobile: 678-361-5559

Managing Partner/Founder

Brent@BuyDirectFromSuppliers.com



凸面平焊法兰
Convex welded flange



JB/T82-94对焊法兰
JB/T82-94 welded flange



国际、美标带颈平焊法兰
GB、American standard with
a neck flat welding flange



HG200600 P/J/R/J
松套平焊法兰(活动法兰)
Loose set of flat welding flange



盲盖凸面法兰
Blind convex flange



JB/T86-94
平焊法兰
Flat welding flange